

# SL07B BOLLARD PATH LIGHT

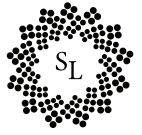

# FEATURES AND SPECIFICATIONS SHEET FOR THE SL07B

FIXTURE: DEDICATED LED PATH LIGHT		
NAME: SL07B	TYPE: DEDICATED LOW VOLTAGE LED	WEIGHT: 4.5LBS
LIGHT SPREAD: 16FT-24FT	OPERATING VOLTAGE: 9V -15V AC	WATTAGE: 4.2W
COLOR TEMP: 3000K	WIRE LEAD: 10' 18AWG	LUMEN OUTPUT: 450LM

## INTENDED USE

This fully dedicated fixture is the ideal solution for landscape lighting professionals to illuminate large, open areas in style. With an open light source and a beautifully frosted lens, this path light is perfect for walkways, driveways, garden beds, small commercial properties, and more. Never miss a step with this powerful fixture.

## CONSTRUCTION

The exterior casing is crafted from marine-grade, virgin brass with a beautiful antique finish. Perfectly balanced and weighing in at a hefty 4.5lbs, this light is not only aesthetically pleasing, but also designed for durability.

## ELECTRICAL SYSTEM

All electronic drivers comply with US and Canadian electrical codes. Easy replacement of driver and LED cup if service is needed.

## LISTING

ETL 5003824, UL1838, RoHS rated.

Note: Patent pending driver technology using CREE CXB chip.

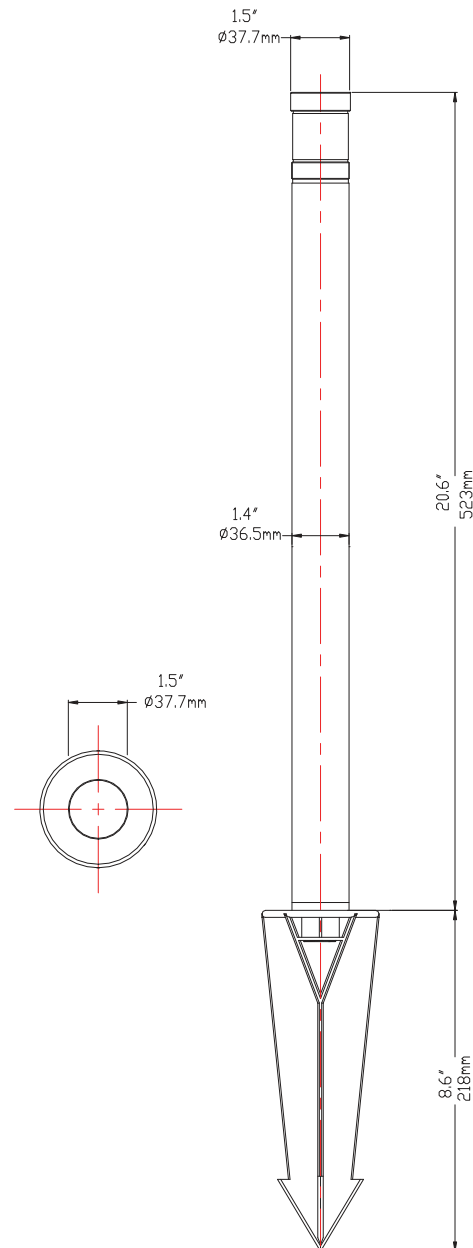

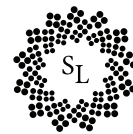

Electrical Test Conditions						
Temp	Voltage	Current	Power	Power Factor	Frequency	Current THD
24.7 °C	14.00 VAC	0.5923 A	5.077 W	0.612	60 Hz	125 %

Summary of Results	
Integrating Sphere	
Total Lumen Output	203.8 lm
Luminaire Efficacy	40.2 lm/w
CCT	3077 K
CRI	86.6
Duv	-0.0005
TM-30 Rf	85.6
TM-30 Rg	99.1

Goniophotometer	
Maximum Candela	54 cd
Location of Max	0 H 0 V
Total Lumen Output	206 lm
Field Lumens	205 lm
Beam Lumens	186 lm
Spill Light Lumens	1 lm
Field Angle	166.3 H X 166.3 V
Beam Angle	140.7 H X 140.7 V
IESNA Type	7 H X 7 V

Color Rendering Index Details	
Ra (CRI)	86.6
R1	85.6
R2	92.0
R3	97.1
R4	86.4
R5	85.8
R6	90.4
R7	86.8
R8	68.4
R9	26.9
R10	81.7
R11	87.1
R12	76.0
R13	87.1
R14	98.4

Chromaticity Coordinates	
Chromaticity (x)	0.4307
Chromaticity (y)	0.4006
Chromaticity (u)	0.2480
Chromaticity (v)	0.3461
Chromaticity (u')	0.2480
Chromaticity (v')	0.5191
Duv	-0.0005

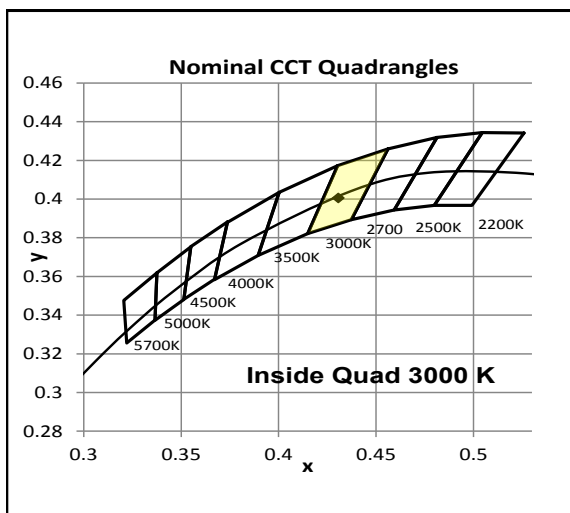
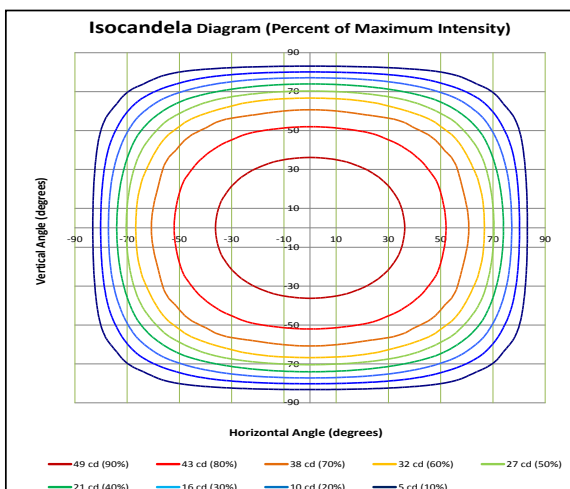
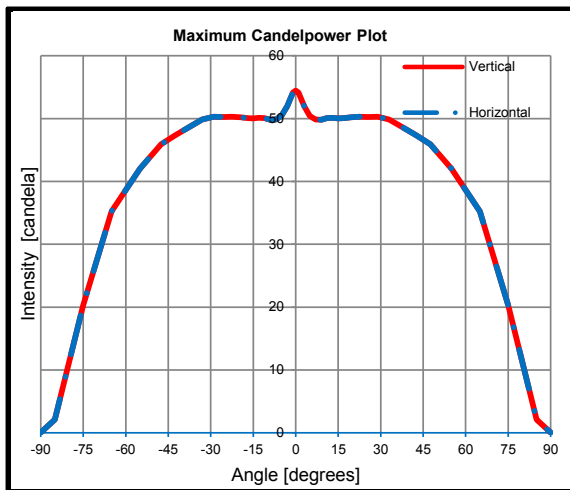

Intensity (Candlepower) Summary		
Angle	Vertical	Horizontal
-85	2	2
-75	20	20
-65	35	35
-55	42	42
-48	46	46
-43	47	47
-38	49	49
-33	50	50
-29	50	50
-26	50	50
-23	50	50
-20	50	50
-17	50	50
-15	50	50
-13	50	50
-11	50	50
-9	50	50
-7	50	50
-5	50	50
-3	52	52
0	54	54
3	52	52
5	50	50
7	50	50
9	50	50
11	50	50
13	50	50
15	50	50
17	50	50
20	50	50
23	50	50
26	50	50
29	50	50
33	50	50
38	49	49
43	47	47
48	46	46
55	42	42
65	35	35
75	20	20
85	2	2

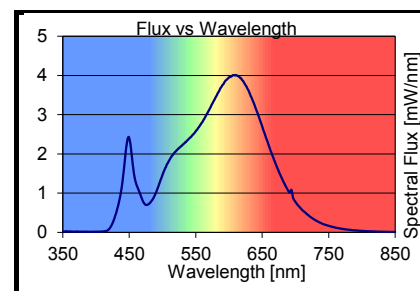

Testing was performed in accordance with LM-79-08  
 The results contained in this summary pertain only to report #12305664.04

\*This photometric report was completed on the SL07 Path Light, which has the same electrical components as the SL07B Bollard Light.

# WHY THE SL07B OUTSHINES THE COMPETITION



- Constructed of marine-grade, virgin brass. Feel, see, experience the difference!
- Includes standard 10' wire lead to minimize the length of connection needed, simplifying installations.
- Constructed with high quality CREE LED chips. CREE is the leading LED source provider in the world.
- This quality fixture weighs over 4lbs.
- Elegant design that blends into any landscape providing a 24' spread of light.
- Smarter design that complies with IDA guidelines to minimize light pollution.
- Ongoing research and development, staying a step ahead of the competition.